

Creating Google Service Account JSON

1.

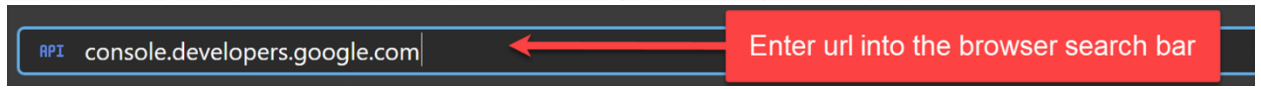

2.

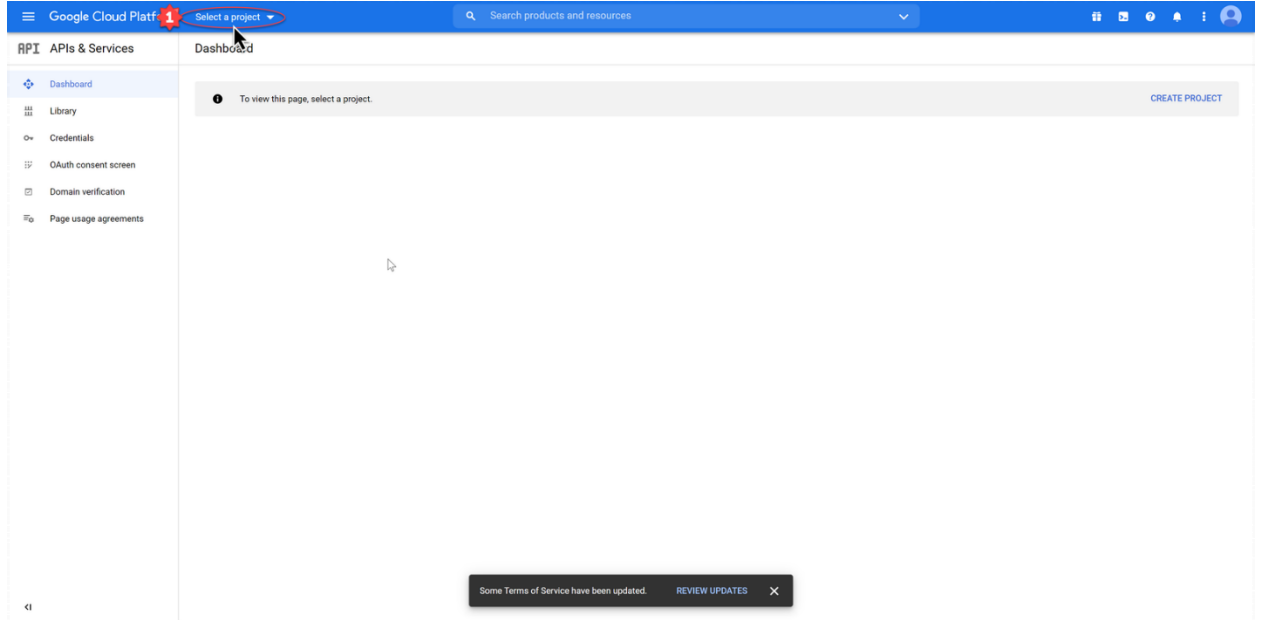

3.

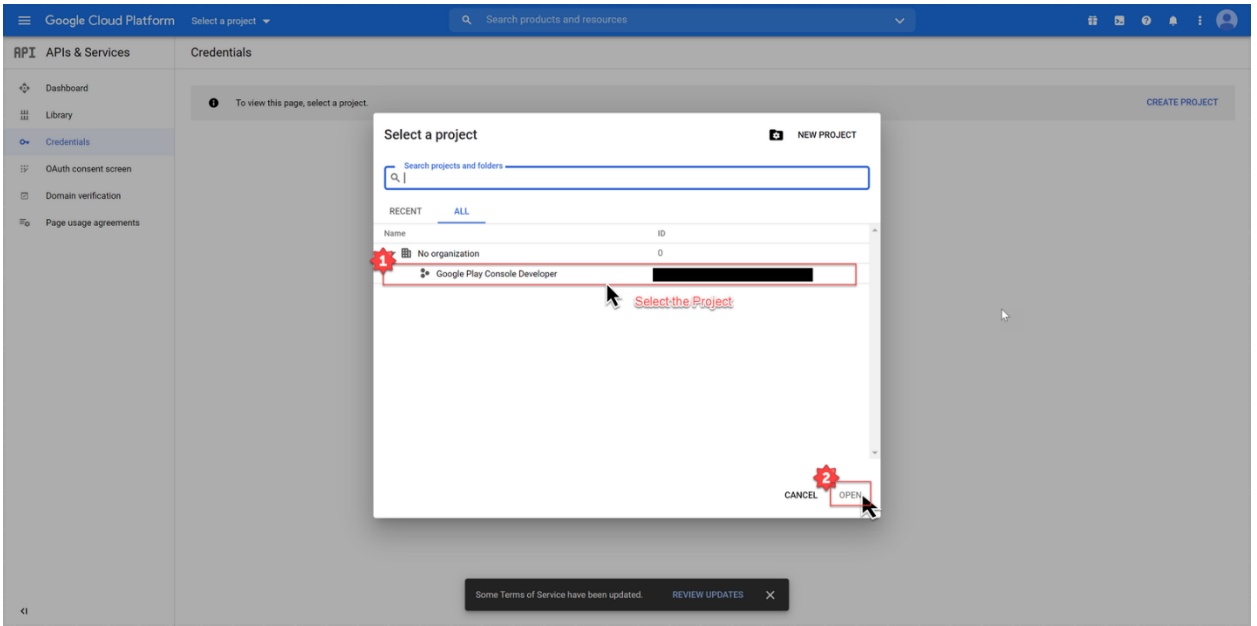

4.

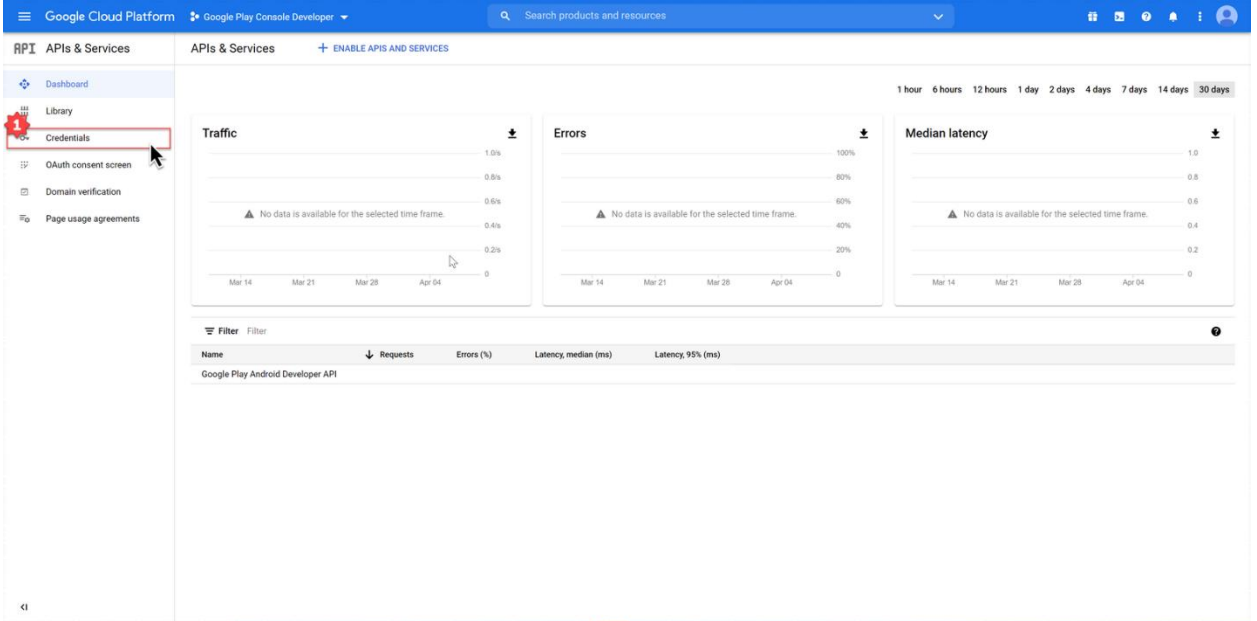

5.

Google Cloud Platform | Google Play Console Developer | Search products and resources

APIs & Services | Credentials | + CREATE CREDENTIALS | DELETE

Create credentials to access your enabled APIs. [Learn more](#)

Remember to configure the OAuth consent screen with information about your application. [CONFIGURE CONSENT SCREEN](#)

API Keys

<input type="checkbox"/>	Name	Creation date ↓	Restrictions	Key
No API keys to display				

OAuth 2.0 Client IDs

<input type="checkbox"/>	Name	Creation date ↓	Type	Client ID
No OAuth clients to display				

Service Accounts [Manage service accounts](#)

<input type="checkbox"/>	Email	Name ↑
No service accounts to display		

6.

Google Cloud Platform | Google Play Console Developer | Search products and resources

APIs & Services | Credentials | + CREATE CREDENTIALS | DELETE

Create credentials to access your enabled APIs. [Learn more](#)

Remember to configure the OAuth consent screen with information about your application. [CONFIGURE CONSENT SCREEN](#)

API Keys

<input type="checkbox"/>	Name	Creation date ↓	Restrictions	Key
No API keys to display				

OAuth 2.0 Client IDs

<input type="checkbox"/>	Name	Creation date ↓	Type	Client ID
No OAuth clients to display				

Service Accounts [Manage service accounts](#)

<input type="checkbox"/>	Email	Name ↑
No service accounts to display		

Help me choose
Asks a few questions to help you decide which type of credential to use

- API key**
Identifies your project using a simple API key to check quota and access
- OAuth client ID**
Requests user consent so your app can access the user's data
- Service account**
Enables server-to-server, app-level authentication using robot accounts

7.

8.

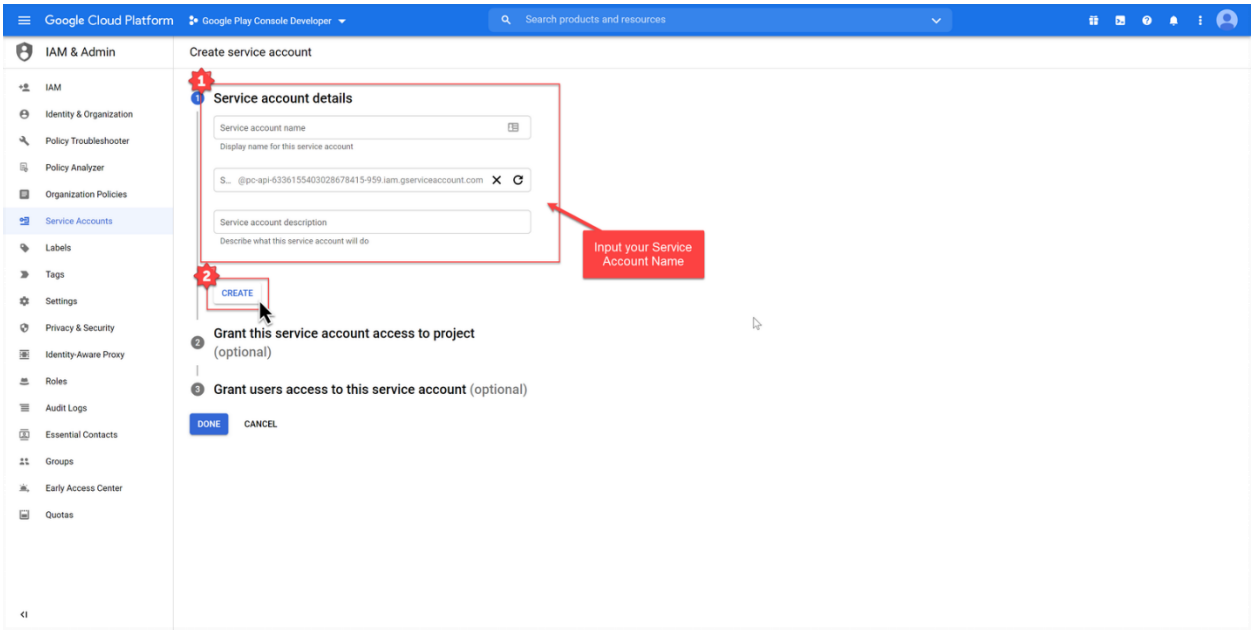

9.

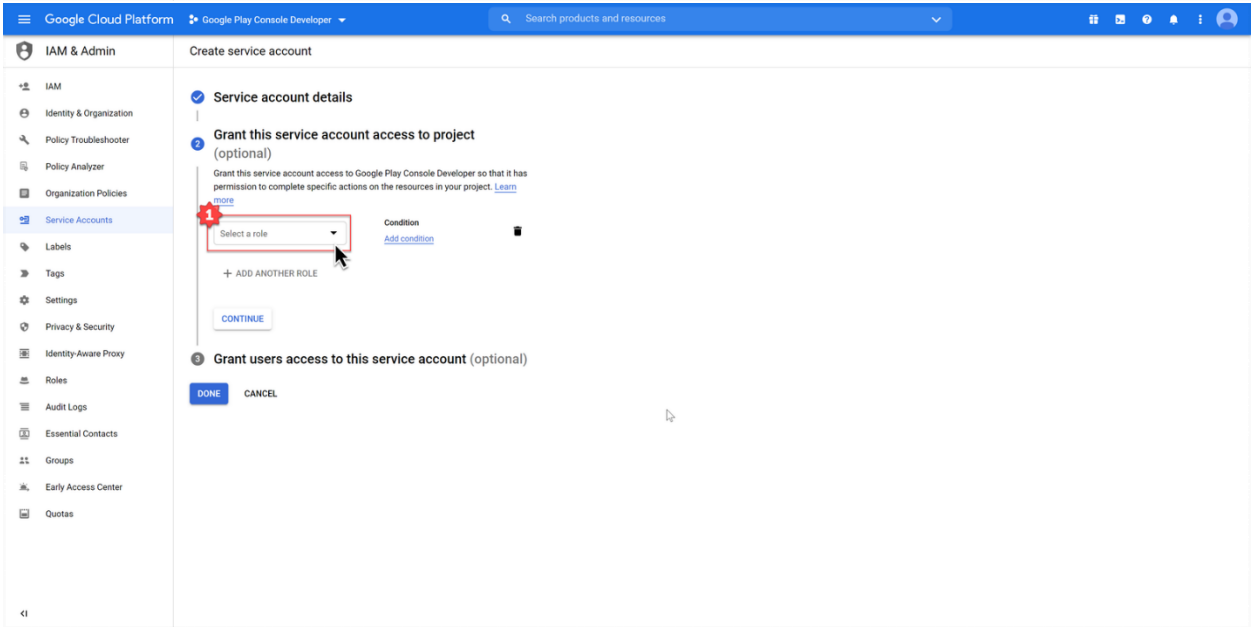

10.

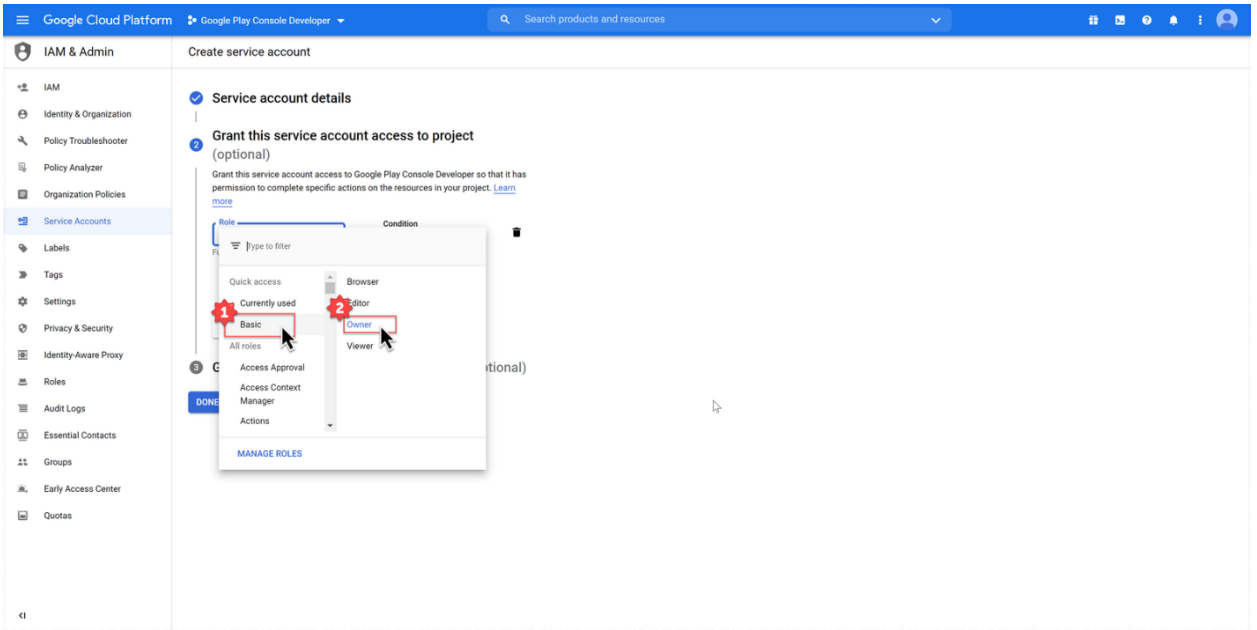

11.

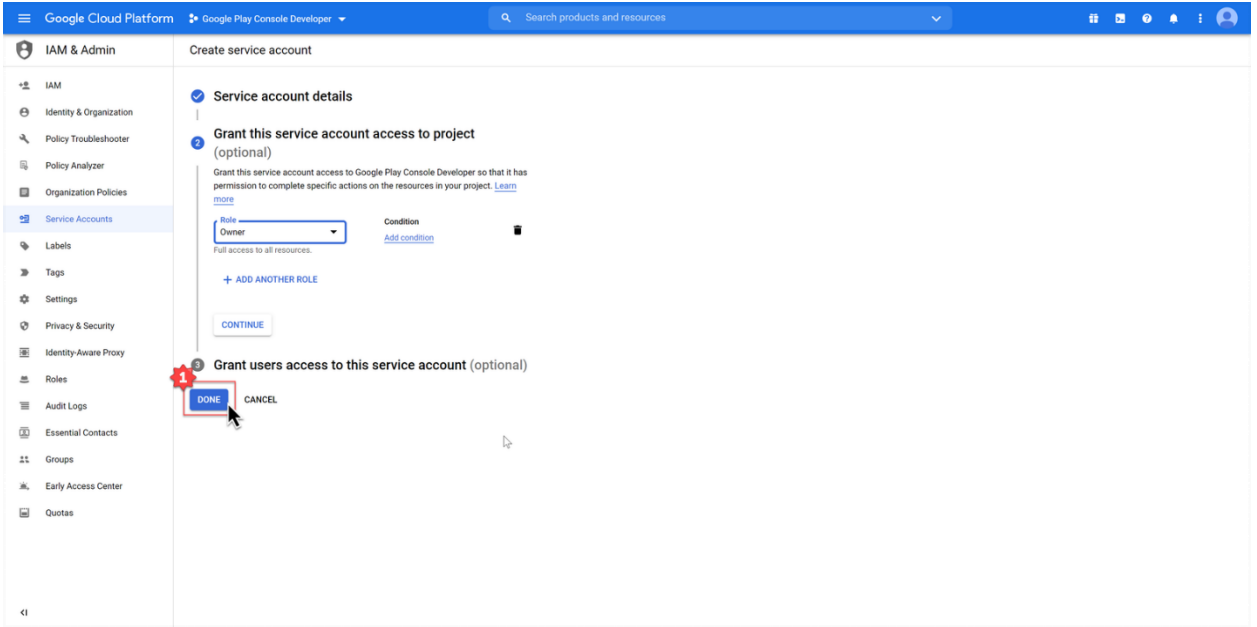

12.

Google Cloud Platform | Google Play Console Developer | Search products and resources

IAM & Admin | Service accounts | + CREATE SERVICE ACCOUNT | DELETE | MANAGE ACCESS

Service accounts for project "Google Play Console Developer"

A service account represents a Google Cloud service identity, such as code running on Compute Engine VMs, App Engine apps, or systems running outside Google. [Learn more about service accounts.](#)

Organization policies can be used to secure service accounts and block risky service account features, such as automatic IAM Grants, key creation/upload, or the creation of service accounts entirely. [Learn more about service account organization policies.](#)

Filter: Enter property name or value

Email	Status	Name	Description	Key ID	Key creation date	Actions
[REDACTED]	✓	FinLocker Service	FinLocker Service	No keys		[Red circle highlights Actions menu icon]

13.

Google Cloud Platform | Google Play Console Developer | Search products and resources

IAM & Admin | Service accounts | + CREATE SERVICE ACCOUNT | DELETE | MANAGE ACCESS

Service accounts for project "Google Play Console Developer"

A service account represents a Google Cloud service identity, such as code running on Compute Engine VMs, App Engine apps, or systems running outside Google. [Learn more about service accounts.](#)

Organization policies can be used to secure service accounts and block risky service account features, such as automatic IAM Grants, key creation/upload, or the creation of service accounts entirely. [Learn more about service account organization policies.](#)

Filter: Enter property name or value

Email	Status	Name	Description	Key ID	Key creation date	Actions
[REDACTED]	✓	FinLocker Service	FinLocker Service	No keys		[Red circle highlights Actions menu, 'Manage keys' is selected]

- Manage details
- Manage permissions
- Manage keys
- View metrics
- View logs
- Disable
- Delete

14.

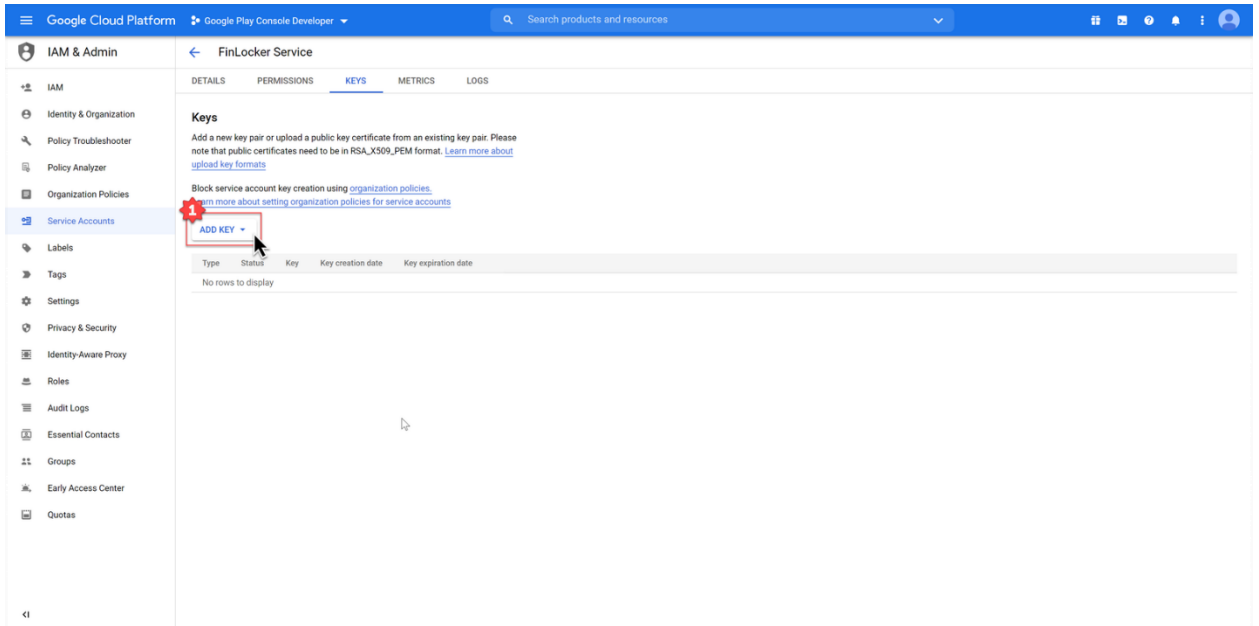

15.

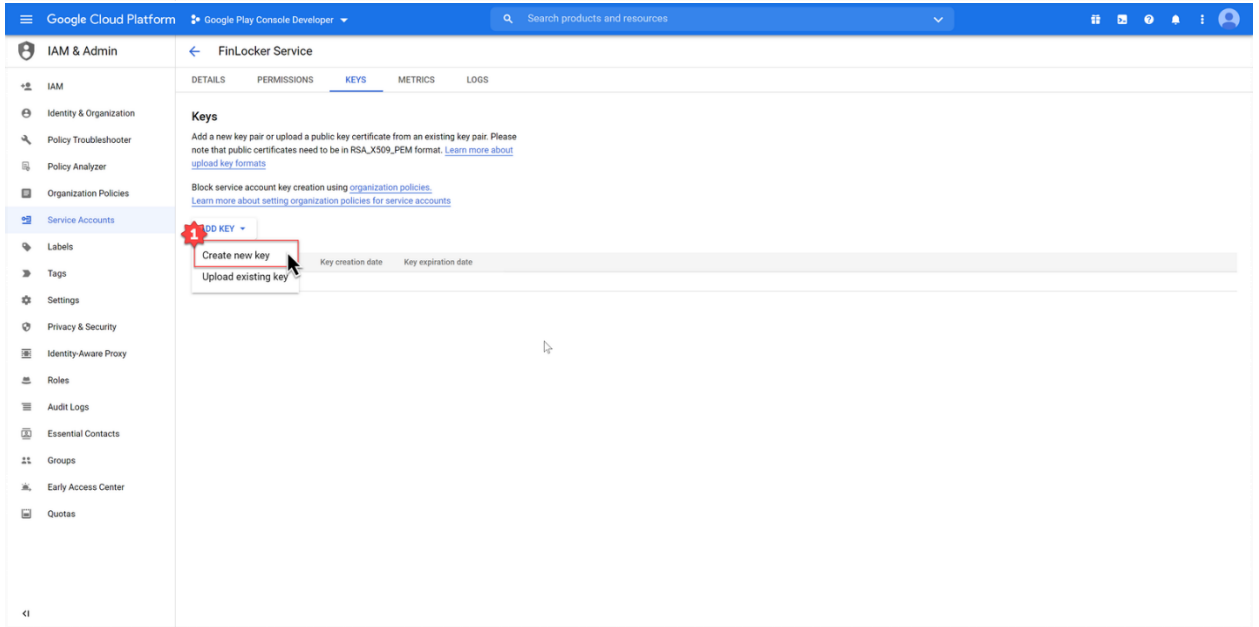

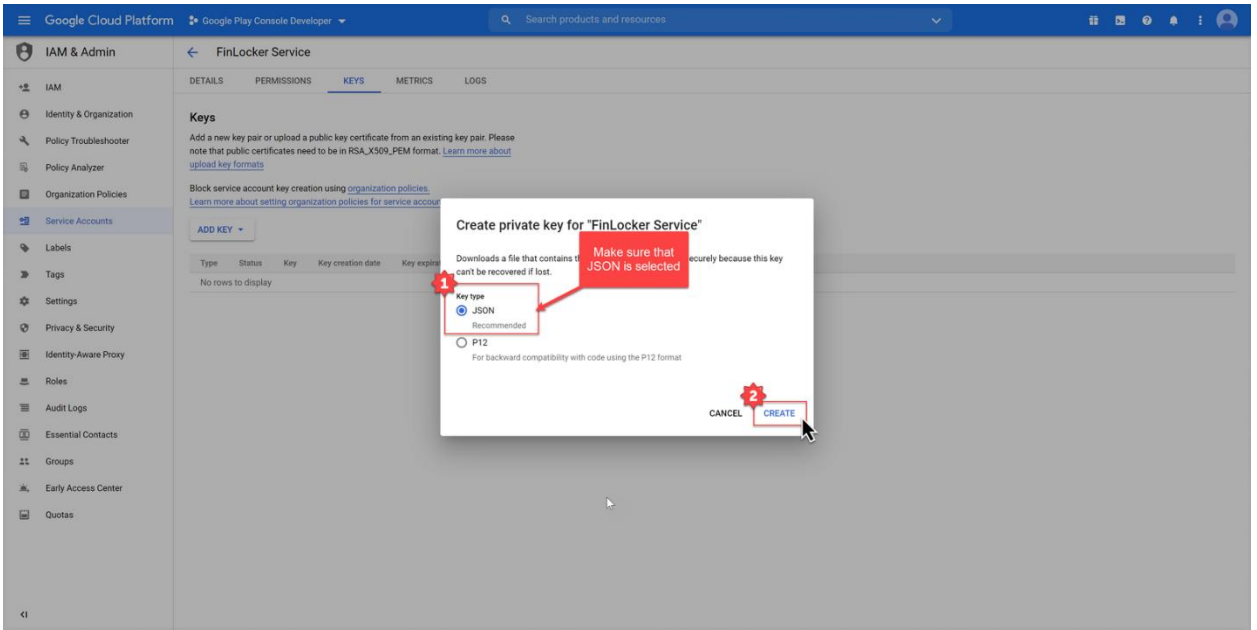

16.

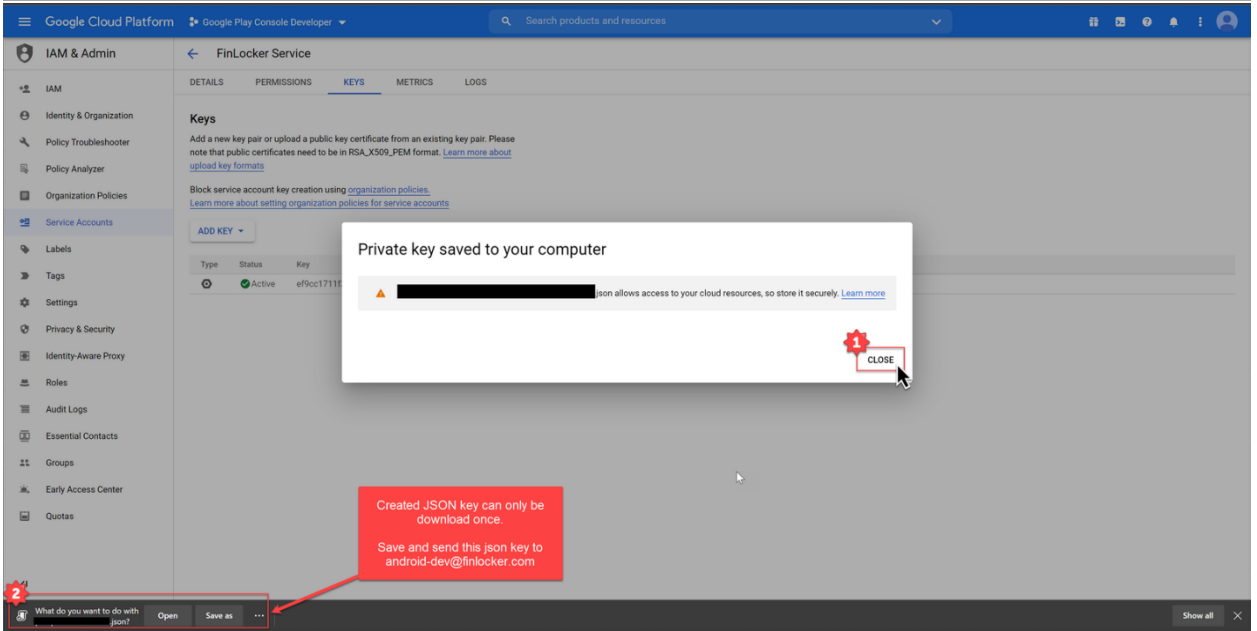

17.